

A3 → A4 reduction.

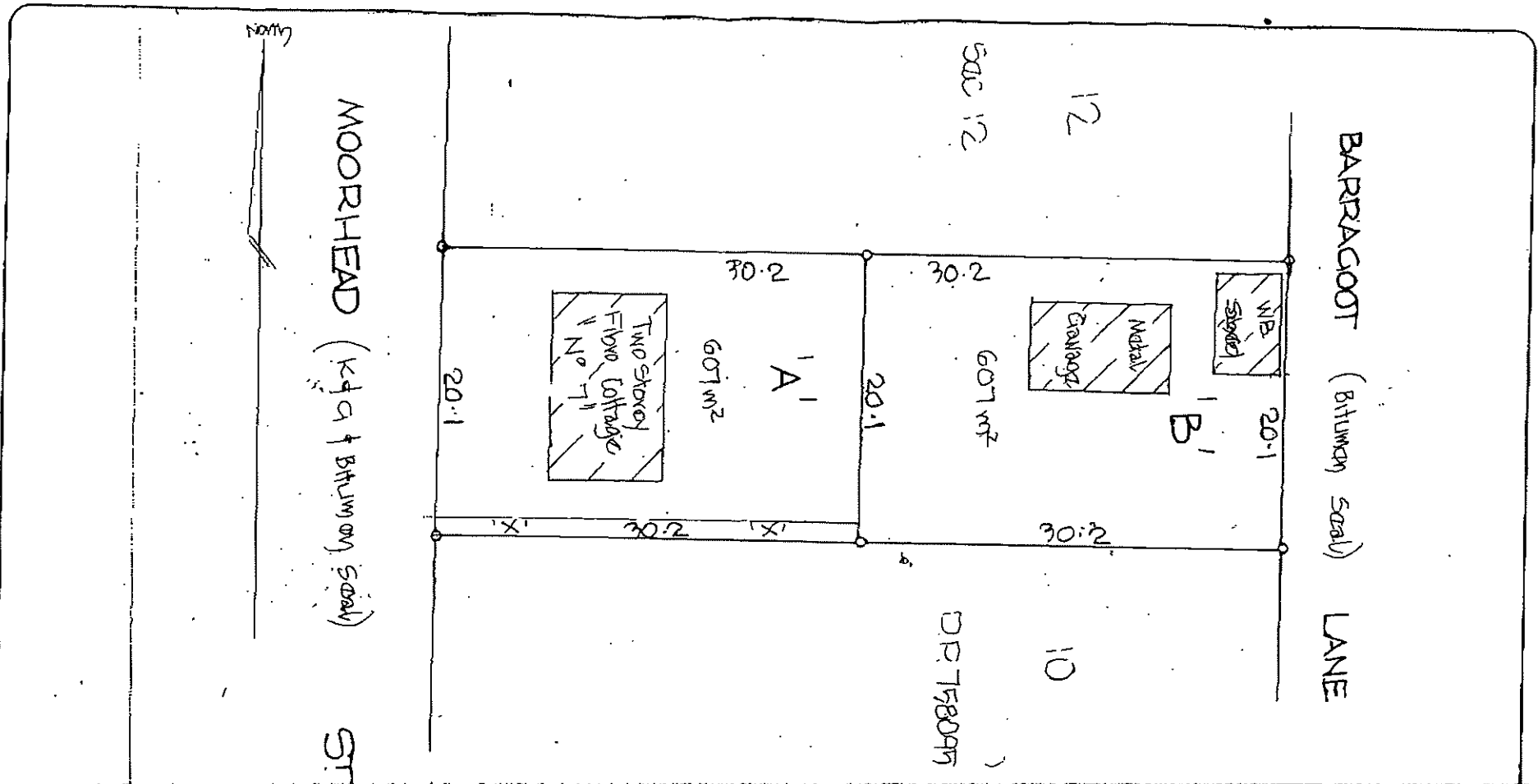

'X' Proposed Easement for Services & Easement to Drain Watch 1 wide

1) THIS PLAN WAS PREPARED FOR THE PURPOSE AND EXCLUSIVE USE OF -
CLARENCE M. S. HUOT
 TO ASSIST HIM IN HIS APPLICATION TO BEGA VALLEY SHIRE COUNCIL FOR APPROVAL TO SUBDIVIDE THE LAND DESCRIBED IN THE PLAN AND IS NOT TO BE USED FOR ANY OTHER PURPOSE OR BY ANY OTHER PERSON OR CORPORATION, ENTITY SEARL AND JARMAN AND ANY PARTNER OR EMPLOYEE THEREOF AND IS NOT RESPONSIBLE FOR ANY LOSS OR DAMAGE

SUFFERED HOWEVER ARISING TO ANY PERSON OR CORPORATION WHO MAY USE OR RELY ON THIS PLAN IN CONTRAVENTION OF THIS CLAUSE OR CLAUSES 2, 3 OR 4 HEREOF.

- 2) THE CONTOURS SHOWN ON THIS PLAN ARE BY - (Refer to Appendix A)
 A - ALTIMETER SURVEYING
 B - TAKEN FROM TOPOGRAPHIC/CARTOGRAPHIC MAP NO.
 C - CADDEY SEARL AND JARMAN PLAN REF NO.
 AND ARE SUITABLE ONLY FOR THE PURPOSES OF THIS APPLICATION. THE

AGREEMENT OF THE CONTAINED HAS NOT BEEN VERIFIED AND NO WARRANTY SHOULD BE PLACED ON SUCH CONTAINERS FOR ANY PURPOSE OTHER THAN FOR THE PURPOSE OF THE APPLICATION FOR RECORDING/REGISTRATION.

3) THE DIMENSIONS, MEAS, AREA AND LOCATION OF IMPROVEMENTS, FLOOR LEVELS OF BUILDINGS, NUMBER OF LOTS AND AGRICULTURAL LAND CLASSIFICATION AREAS SHOWN ON THIS PLAN ARE APPROXIMATE ONLY AND MAY VARY.

4) THIS PLAN MAY NOT BE PHOTOCOPIED UNLESS THIS NOTE IS INCLUDED.

CADDEY SEARL AND JARMAN
 CONSULTING SURVEYORS AND VALUERS
 10 DANBROOK STREET BEGA NSW 2650
 PHONE: 089-822933
 80 MAIN STREET BERAMUNGA NSW 2548
 PHONE: 089-851044
 LAMONT ST, BERMAQUIL
 ANGELA'S ARCADE
 MELAY ST, EDEN

Parish: Barmagul
 County: Dampier
 Shire: Bega Valley
 Locality: Barmagul

Scale: 1:300 (Metres)
 Drawn: ART
 Date: 30/11/10
 Ref: 63789

Plan of Proposed Subdivision
 of Lot 11, Sec 12, D.P. T58097